

MDTE Series

Wire Wound Molded SMD Power Inductors

Size 7030



FEATURES

- Molded
- Wire Wound
- SMD
- Power Inductor
- Size 7030
- Marking: C

APPLICATION

- Power Inductor
- SMD

Dimensions: [mm]

Land Pattern: [mm]

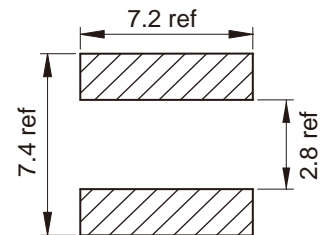
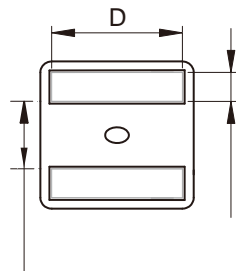
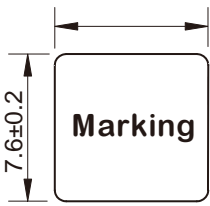

Electrical Properties:

	(μ H)		Satura on (A)	Satura on (A)	(A)	(m)	(mm)

Saturation Current will cause L to drop approximately 30%

Temperature Rise Current: The actual value of DC current when the temperature rise is $\Delta T=40^{\circ}\text{C}$

Soldering Reflow:

Preheat condition: 150 ~200°C / 60~120 sec.

Allowed time above 217°C: 60~90 sec.

Max temperature: 260°C.

Max time at max temperature: 10 sec.

Allowed Reflow time: 2x max.



Packaging Information:

Tape Dimension:

Series	A0 (mm)	B0 (mm)	D (mm)	P0 (mm)	P1 (mm)	W (mm)	K0 (mm)	E (mm)	T (mm)
MDTE7030	8.2±0.1	8.0±0.1	1.5±0.1	4.0±0.1	12.0±0.1	16.0±0.3	3.3±0.1	1.75±0.1	0.35±0.05

Peel force of top cover tape:

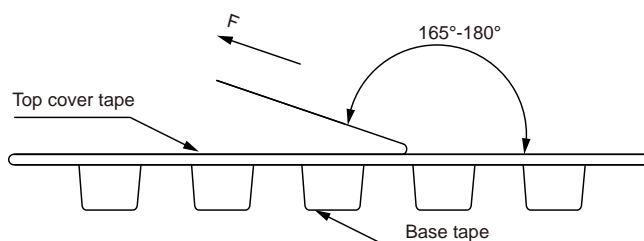

The peel force of top cover tape shall be between 0.1 to 1.3 N

Reel Dimension: [mm]



Packaging Quantity: