

SMD Low Profile High Current Molded Inductor Size 7020

Inductance
@ 100KHz/1V

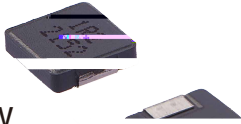

DC
Resistance
Max.

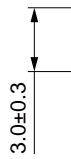

MD7020-R10N	0.10	21	40	20	24
MD7020-R15N	0.15	18	39	2.3	27
MD7020-R22N	0.22	15		3.5	4.0
MD7020-R33M	0.33	14	25	4.5	5.0
MD7020-R47M	0.47	11.7	20	7.1	8.3
MD7020-R56M	0.56	11	18	7.9	9.3
MD7020-R68M	0.68	10.5	16	8.3	10
MD7020-1R0M	1.00	8.0	14	16.5	18
MD7020-1R5M	1.50	7.0	12		
MD7020-2R2M	2.20	6.0	10		
MD7020-3R3M	3.30	5.0	8.0	43	48
MD7020-4R7M	4.70	4.5	7.0	53	60
MD7020-5R6M	5.60	4.0	6.0	59	68
MD7020-6R8M	6.80	4.0	5.5	63	
MD7020-8R2M	8.20	3.2	5.0	101	116

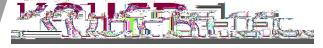

Part No	Inductance @ 100KHz/1V	Tolerance	Temperature Rise Current Typ. (A)	current Typ. (A)	DC Resistance Typ.	DC Resistance Max.
MD7020-100M	10.0	±20%	2.8	4.0	134	154
MD7020-150M	15.0	±20%	2.1	3.3	190	210
MD7020-220M	22.0	±20%	1.5	2.5	236	280

Operating temperature: -40°C ~ +125°C

Temperature rise current: The actual value of DC current when the temperature rise is T40C

Saturation Current will cause L to drop approximately 30%

Typical Electrical Characteristics:

